

Waihinga Park

for

South Wairarapa District Council

Issue History				
Issue	Sheet	Rev	Sheet Name	Change ID
01, Plans for pricing, 15/04/2019 5:12 PM				
	01		Cover Page	
	A102	01	Ground Floor Plan	
	A103	01	Ground Floor Plan	
02, Waihinga Centre Pricing plans Rev 02, 24/06/2019 1:11 PM				
	01		Cover Page	
	A102	01	Ground Floor Plan	
	A103	01	Ground Floor Plan	

Sheet Index			
Layout ID	Layout Name	Issued	Remark
	Cover Page	<input checked="" type="checkbox"/>	
A101	Site Plan	<input type="checkbox"/>	
A102	Ground Floor Plan	<input checked="" type="checkbox"/>	
A103	Ground Floor Plan	<input checked="" type="checkbox"/>	
A104	Ground Floor Plan	<input type="checkbox"/>	
A105	Ground Floor Framing Plan	<input type="checkbox"/>	
A106	Ground Floor Plumbing Plan	<input type="checkbox"/>	
A107	Ground Floor Reflected Ceiling Plan	<input type="checkbox"/>	
A108	Roof Plan	<input type="checkbox"/>	
A201	Sections	<input type="checkbox"/>	
A301	Elevations	<input type="checkbox"/>	
A401	Details	<input type="checkbox"/>	
A501	Door & Window Schedule	<input type="checkbox"/>	
A601	Sun Study Dec 22 @ 9am	<input type="checkbox"/>	
A602	Sun Study Dec 22 @ 12pm	<input type="checkbox"/>	
A603	Sun Study Dec 22 @ 3pm	<input type="checkbox"/>	
A604	Sun Study Mar / Sep 22 @ 9am	<input type="checkbox"/>	
A605	Sun Study Mar / Sep 22 @ 12pm	<input type="checkbox"/>	
A606	Sun Study Mar / Sep 22 @ 3pm	<input type="checkbox"/>	
A607	Sun Study Jun 22 @ 9am	<input type="checkbox"/>	
A608	Sun Study Jun 22 @ 12pm	<input type="checkbox"/>	
A609	Sun Study Jun 22 @ 3pm	<input type="checkbox"/>	
A701	Perspective	<input type="checkbox"/>	

RevID	ChID	Revision	Date
01	EXI		15/04/2019
	RET		

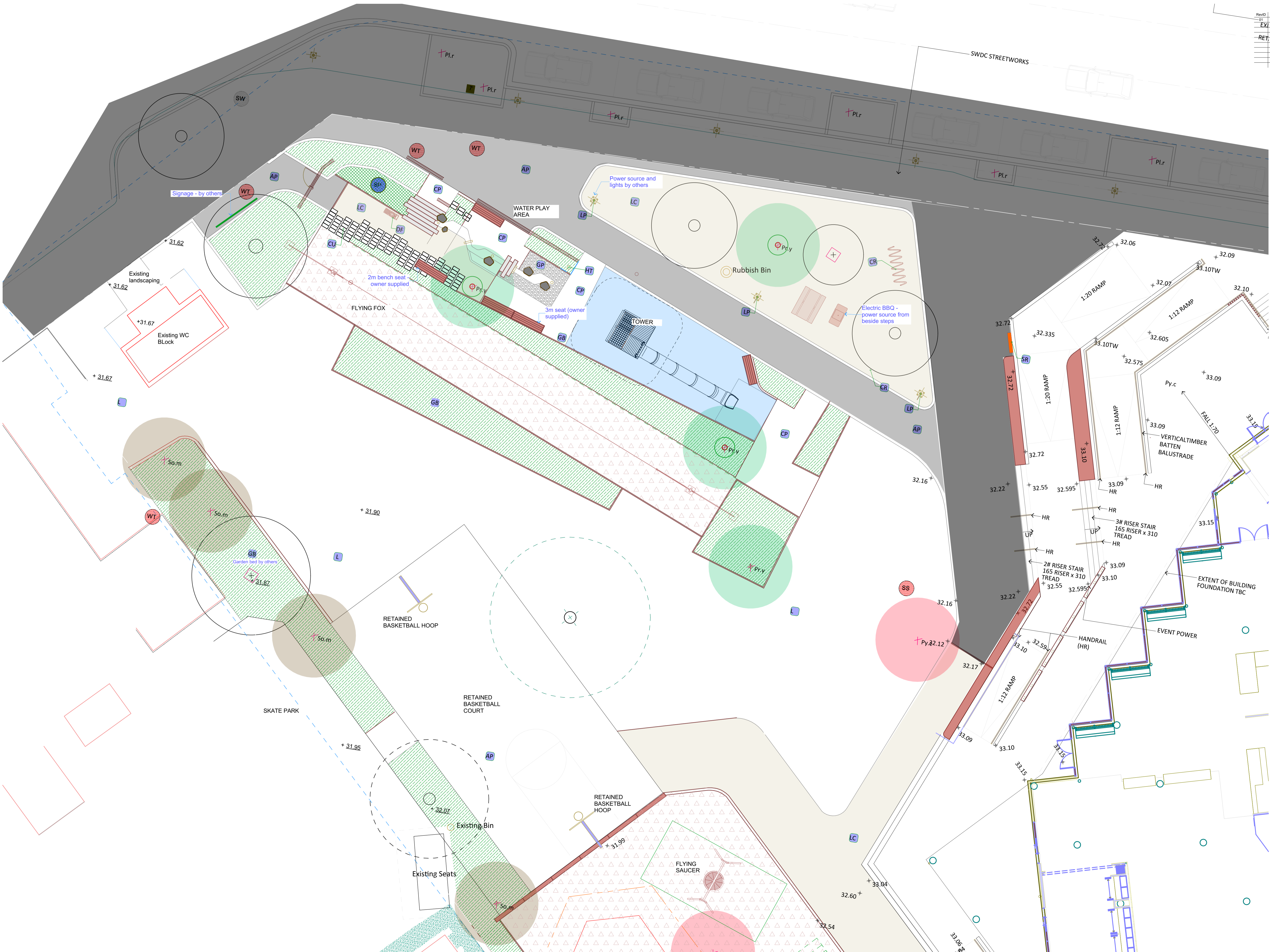

South Wairarapa District Council
 Wainga Park
 The Square
 Martinborough

Kitchener St Martinborough
 PHONE: 063098611

SHEET TITLE: Ground
 Floor Plan
 REVISION: 01
 SCALE: 1:100
 ISSUED: 24/06/2019
 ISSUE: Plans for pricing

A102
 REV 01

SWDC

© Urban/Vision Road/Owner - Victoria Road Architecture/Wainga Centre/Stage 02/Design/Stage 02/Issued Rev 03.dwg

RevID	ChID	Revision	Date
01			15/04/2019

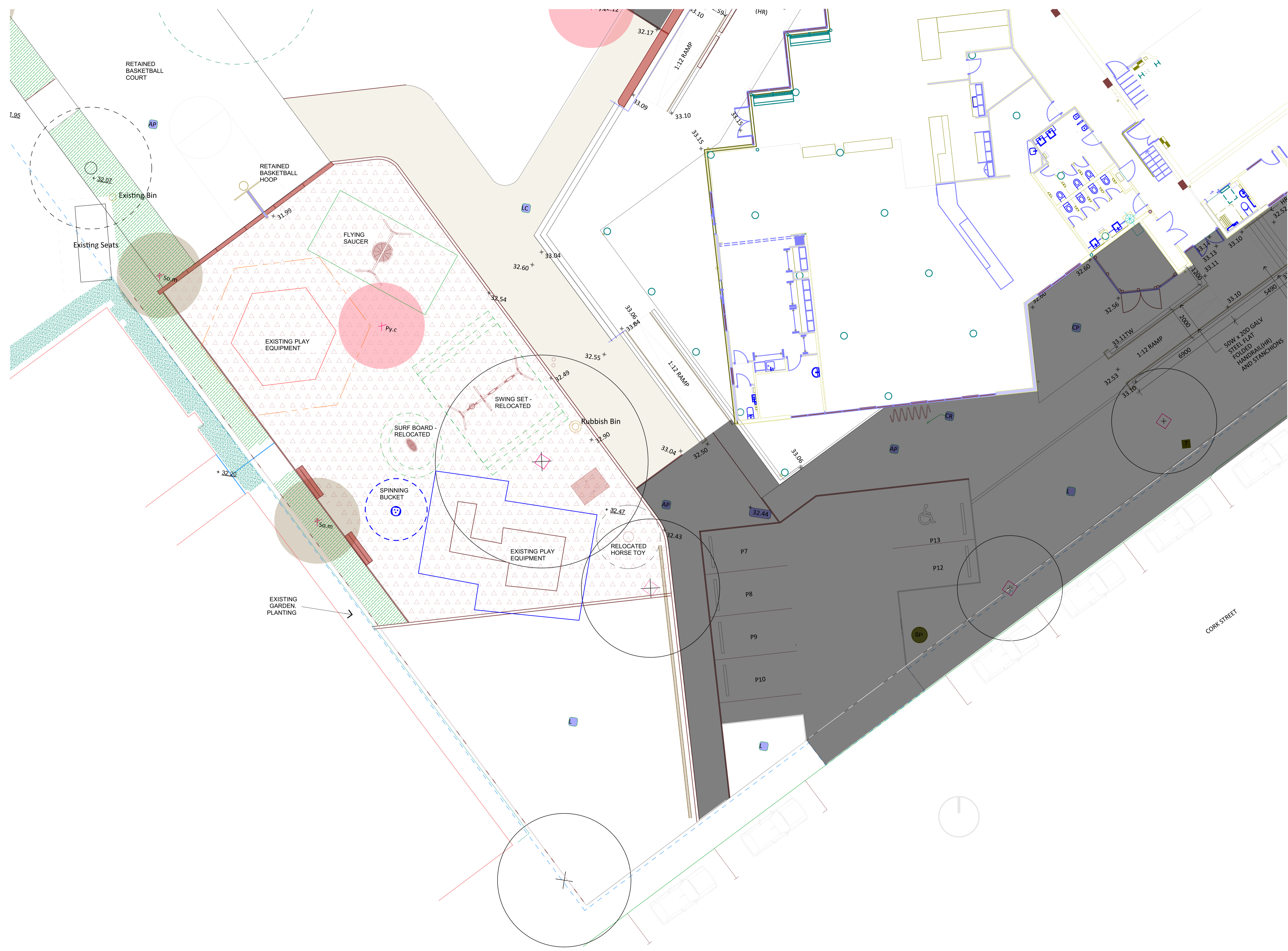

South Wairarapa District Council
Waiinga Park
The Square
Martinborough

Kitchener St Martinborough
 PHONE: 063098611

SHEET TITLE: Ground
 Floor Plan
 REVISION: 01
 SCALE: 1:100
 ISSUED: 24/06/2019
 ISSUE: Plans for pricing

A103
 REV 01

© User/Visio Read/Owner - Visio Read Architects/Waiinga Centre/Stage 02/Design/Stage 02/Issued Rev 03.dwg

Waihinga Charitable Trust - funds for stage 2

Funding for contract with Infinite Landscapes

Total funds available for landscaping:	324919
Less funds spent to date:	17500
Balance available for landscaping:	307419

Separate funding

TOWER

Cost of Tower	60000
Funds for tower: (50K from Lions, 10K from Trust House)	60000
Balance	0

WATERPLAY ITEMS

Cost of waterplay items	16758
Funds for waterplay area:	7700
Balance needed	9058 * Fundraising ongoing

DONATED EQUIPMENT

Contra support includes physical items donated Basketball hoops, bike stands, drinking fountain, 2 x park benches, Flying saucer play item, inclusive spinner play item, BBQ, 2 x picnic tables	55087
Balance	0

QUOTE

South Wairarapa District Council
19 Kitchener Street
Martinborough 5741

Date
25 Jun 2019

Quote Number
QU-0002

Infinite Landscapes Limited
PO BOX 12
Greytown 5742
NEW ZEALAND

Te Waihinga Park

Item	Description	Quantity	Unit Price	Amount NZD
Tables	Install as per plan	1.00	1,520.00	1,520.00
Water Play Sleepers	As per plan	1.00	11,250.00	11,250.00
Drinking Fountain	Install drinking fountains	1.00	2,337.50	2,337.50
Kerbs	As per plan	1.00	25,302.32	25,302.32
Concrete Pathways	As per plan	1.00	13,816.00	13,816.00
Firth Paving on Concrete Base	As per plan	1.00	17,656.88	17,656.88
Asphalt	As per plan	1.00	13,585.00	13,585.00
Compacted Lime Areas	As per plan	1.00	22,737.50	22,737.50
Grass	As per plan	1.00	50,000.00	50,000.00
Trees	As per plan (Provisional Sum of \$350 for supply of tree)	1.00	11,473.00	11,473.00
BBQ	Install BBQ and install footings	1.00	549.69	549.69
Rubbish Bins	Install rubbish bins and install footings	1.00	640.63	640.63
Rain Garden	As per plan	1.00	3,860.00	3,860.00
Park Playground Chip	As per plan	1.00	12,985.00	12,985.00
Timber Edging	100x50 treated Timber edging with treated 50x50 stake	1.00	4,147.50	4,147.50

Item	Description	Quantity	Unit Price	Amount NZD
Garden Beds	As per plan	1.00	26,169.65	26,169.65
Below Ground Services	(Provisional) - Electrical, water mains, storm water	1.00	6,250.00	6,250.00
Wet Play Area and Soak Pit	(Provisional)	1.00	21,875.00	21,875.00
Softfall Matting	(Provisional) - As per plan	1.00	25,000.00	25,000.00
Park Benches	(Provisional) - As per plan	1.00	2,812.50	2,812.50
Wall Hung Seats	(Provisional) - As per plan	1.00	12,500.00	12,500.00
Contingency	(Provisional)	1.00	20,000.00	20,000.00
			Subtotal	306,468.17
			TOTAL GST	0.00
			TOTAL NZD	306,468.17

Waihanga Centre Playground Martinborough

3/25/2019



Playco Equipment Ltd
21 Wookey Lane
Kumeu
Auckland
0800 76 46 76
www.playco.co.nz

Tower

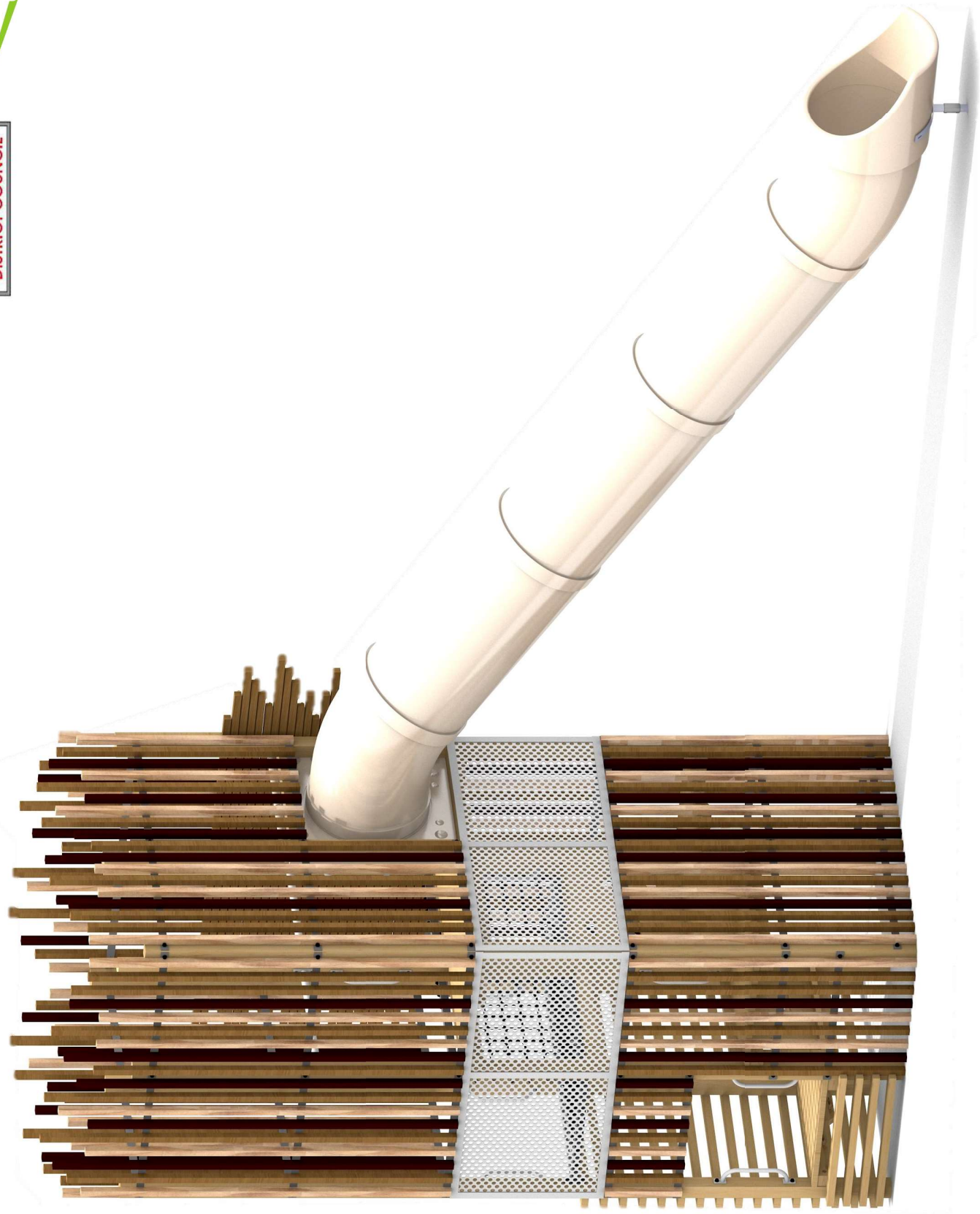

Tower

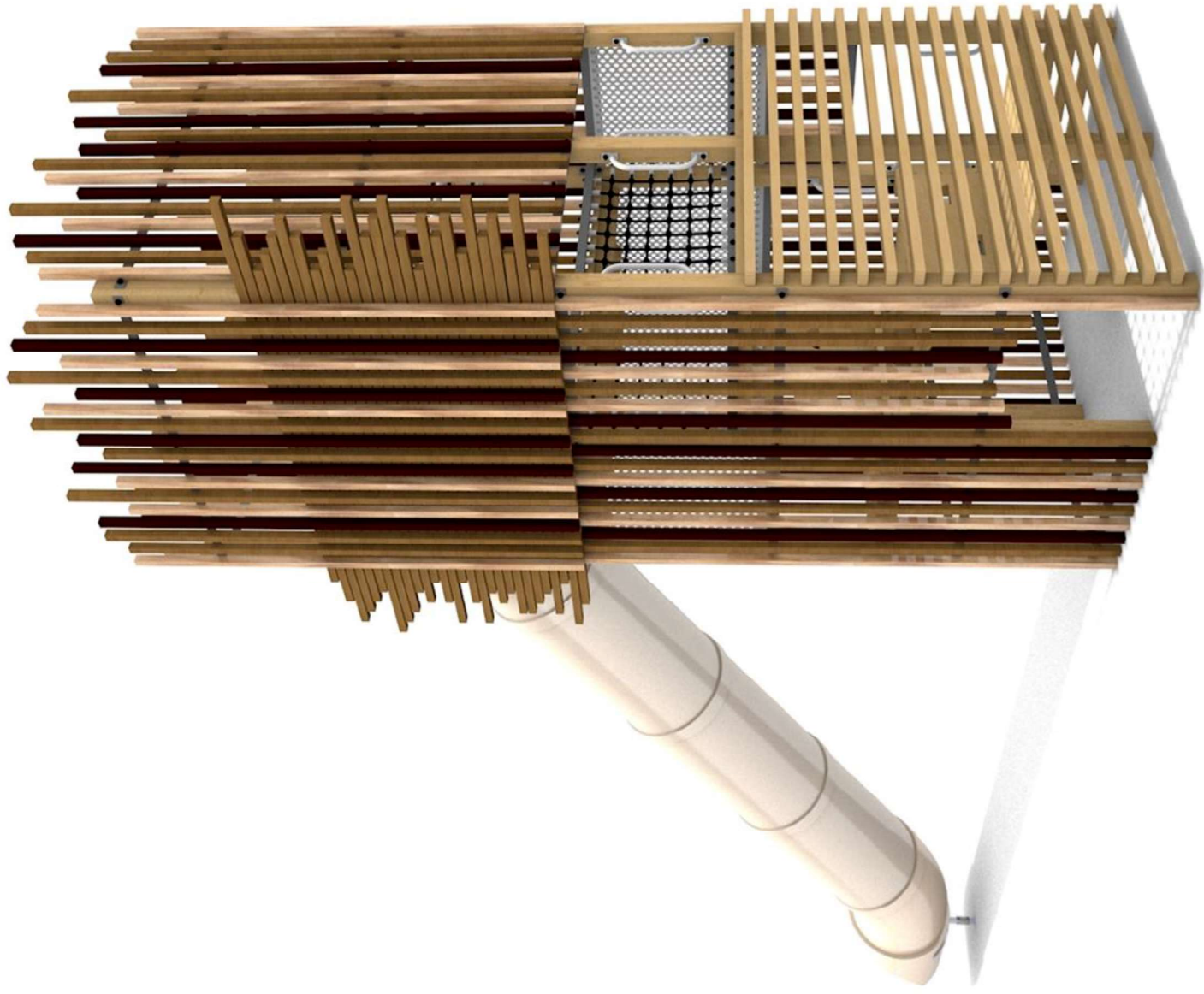

Tower Internal Structure

PINE 45X45mm, H3.2 CCA GAUGED TIMBER CLADDING

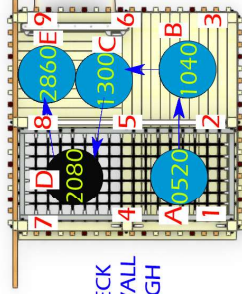

DOUBLE DECK
CLIMBING WALL
2080mm HIGH

CLIMBING WALL
520mm HIGH

SS PERFORATED SHEET
1.3mm THICK
(1860mm high deck to 2860mm deck)

SS PERFORATED SHEET
1.3mm THICK
(1860mm high deck to 2860mm deck)

STRAIGHT TUBE SLIDE
3000mm HIGH

